

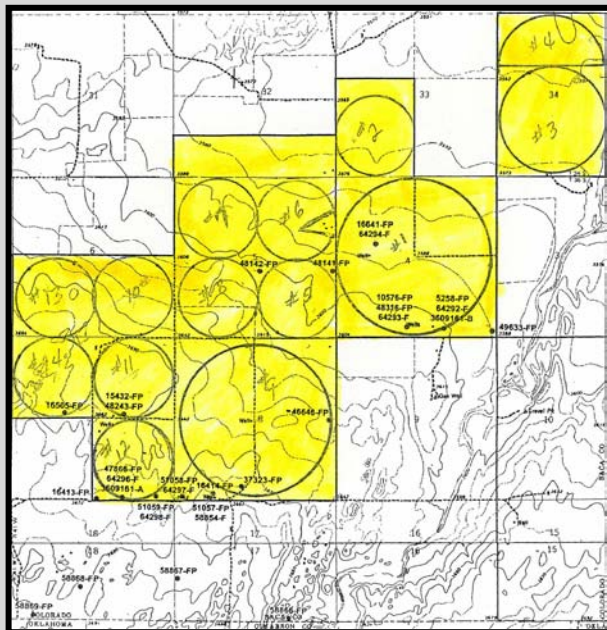

FARM & RANCH REALTY, INC.

**PO BOX 947
COLBY, KS 67701**

**3,500+/- ACRES, IRRIGATED,
DRYLAND, CRP & IMPROVEMENTS
BACA COUNTY, COLO**



IMPROVEMENTS & PROPERTY INCLUDE:

- 3 homes
- 200'x100' shop & equipment storage
- 1,000 head cattle feed yard, excellent cattle working facilities and pens
- Excellent cattle working facilities at Headquarters
- 140,000 bushel grain storage

TRACTS	TOTAL ACRES	FARM LAND ACRES	IRRIGATION ACRES	DRY LAND ACRES	GRASS & FARM STEADS ACRES	WHEAT BASE /DCP YLD	CORN BASE /DCP YLD	GRAIN SORGHUM BASE/DCP YLD	SOYBEANS BASE /DCP YLD
S/2S/2 of 32-34-41	160	157.9		155.2	2.7			45.9/17	
190 ac in W/2 of 33-34-41	190	193.1	122.9	70.2		47.2/31	69.3/49	47.2/39	24.9/38
Lots 1-4, SW/4, NW/4 of 34-34-41	440	434.2	342.9	99.3		94.3/31	188.2/49	92.4/39	
4-35-41	640	636.6	484.1	152.5		173.9/31	289.1/49	38.6/39	62.2/38
5-35-41	640	630.9	465.7	134.6	30.6	96.1/31	203.8/49		30.9/38
Lots 3-4, SE/4, E/2SW/4 of 6-35-41 ; and Lots 1-2, E/2 & E/2NW/4 of 7-35-41	800	796.7	623.3		176.4	173.9/31	289.1/49	38.6/39	62.2/38
8-35-41	640	637.8	494.8	136.1	7.0	123.5/31	326.9/49		
	3,510.0	3,487.2	2,533.7	747.9	216.6	708.9	1,366.4	262.7	180.2

